

# NTS

**NATIONAL  
TIMBER SYSTEMS**  
Part of National Timber Group

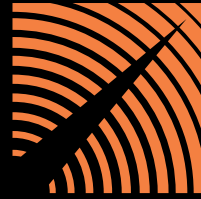

Specialists in off-site  
fabrication since 1979

## SPECIALISTS IN

- + Roof Trusses
- + Engineered Joists
- + NTSROOF® Panelised System
- + Roof & Floor Cassettes
- + Gable & Party Panels

# CONTENTS

## 5 Innovation

Introducing our latest innovations to streamline on-site operations, designed to help our customers to do less with advanced off-site solutions.



## 7 NTSROOF® Panelised Roof System

Engineered and designed in-house, the NTSROOF range provides a panelised roof system for various house types. Supplied nationally.



## 10 Floor & Roof Cassettes

Manufactured in our factory, roof and floor cassettes can be pre-insulated ready for installation on projects across the UK.



## 11 Engineered Joists

Designed in-house to individual requirements from one-off projects to full site plans and complex commercial structures.



## 13 Trussed Rafter

We design, manufacture, and deliver all types of trussed rafters including attics and raised ties.



## 14 Gable & Party Panels

We design and manufacture gable and party wall panels for timber frame and masonry builds – easy to install with no complex anchorage.



## 16 Key Supplier - EGGER

EGGER's portfolio of enhanced moisture resistant structural flooring boards offer a choice of finishes and levels of protection for your project.



## 17 Quality Matters

A continuous improvement initiative showcasing our commitment to quality, the cornerstone of our reputation, customers' trust, and success.



## 18 Sustainability

Overview of sustainable timber sourcing, waste reduction, and carbon management efforts to reduce environmental impact.



## 19 Certifications

Certification for UKCA Marking, ISO9001, FSC® & PEFC. Members of the Trussed Rafter Association. Robust Details accredited.



# DELIVERING OUTSTANDING VALUE FOR OVER 40 YEARS

DESIGN &  
MANUFACTURING  
SITES  
NATIONWIDE

» DESIGNED  
» FABRICATED  
» DELIVERED

Bristol

Newcastle

Catterick

Sheffield

Coming Soon  
Wolverhampton



## Specialists in off-site fabrication since 1979

**National timber Systems Head Office**

Standard House | Thurston Road

Northallerton | North Yorkshire | DL6 2NA

t 01609 780777

e [ntsenquiries@nationaltimbersystems.co.uk](mailto:ntsenquiries@nationaltimbersystems.co.uk)

w [nationaltimbersystems.co.uk](http://nationaltimbersystems.co.uk)

**NTS**  
**NATIONAL  
TIMBER SYSTEMS**  
Part of National Timber Group



# ABOUT US



## LOCAL CONTACTS, NATIONAL DELIVERY

National Timber Systems is the engineered wood products division of National Timber Group, the largest independent added-value timber distribution and processing group in the UK.

We have a long heritage as specialists in the sector and continue to invest in our people and production facilities across the country.

We design, fabricate and deliver a wide range of high-quality timber floor, wall and roof products. And we're proud to be introducing new and innovative products designed to save build time and reduce health and safety risk on site, whilst improving thermal values and reducing the need for steels and blocks.

2026 will see the newest addition to our national presence, Wolverhampton. This site will enhance our strategically positioned locations in Newcastle, Catterick, Sheffield, and Bristol, ensuring extensive and comprehensive nationwide coverage.

Whether you're a single site developer or a national housebuilder, our highly experienced and skilled team of designers, engineers and fabricators can help you deliver your projects on time and on budget.

## What We Offer

- Over 40 years' experience & expertise
- Complete design & engineering service
- Full design & technical product support
- Full chain of custody including ISO9001, PEFC, FSC® and UKCA certification
- Regional & national deliveries
- Reliable & trusted leadtimes
- Quick & effective responses to enquiries
- Additional timber products from stock

# INNOVATION



At National Timber Systems, we are continuously developing innovative solutions to simplify on-site construction by utilising the benefits of off-site manufacturing. Our approach enhances product dimensional accuracy, speeds up build times and promotes safer health and safety standards – all while reducing time spent working at height.

*Explore our latest innovations...*

## SUPER-SPAN® redefining roof construction

SUPER-SPAN® is an all-timber roof construction spanning over 9 metres which eliminates the need for structural internal walls and steels, perfect for large detached homes or dormer bungalows – with all the benefits of the original NTSROOF system.

The unique load-spreading design makes room space simple to design and easy to detail. Starting with the dwarf walls and 4-cassette system, a 9+ metre span room can be constructed in just 3 hours.

SUPER-SPAN is a more sustainable room in the roof solution, without steels or padstones, helping to reduce embedded carbon in the building.



## Benefits of SUPER-SPAN®:

- 4-cassette system
- 3-hour install time
- Unique click and fix solution makes installation simple
- Improves the PSI / U values
- 9+ metre single span
- No steel beams or padstones helps to reduce embedded carbon in the building
- Robust Details compliant

## SIMPLE » SAFE » SECURE



## NTSROOM™ an integrated floor and roof system.

NTSROOM™ is a complete solution with integrated roof and floor system, factory-built and ready to install on site.

Install a pair of semi-detached houses in a day with one delivery, one crane, and one install plan. No high-level steels are required and install starts from a level wall plate and progresses to a complete roof solution. Tailored for comfort, thermal efficiency, and design, NTSROOM can include a cantilevered roof for natural shading..

### Benefits of NTSROOM™:

- NTSROOM is an integrated roof and floor system
- Our range of NTSROOM products are Part L compliant
- Easily installed by local carpentry teams.
- Free 'Supply with Assist' training available for Supply-Only contracts
- Includes pipe and SVP runs, plus robust flooring
- NTSROOM is designed with a floor that has all the holes drilled.
- This allows for install of pipes, and cables without the need for holes being drilled on site.
- Each NTSROOM is sent with a drawing of the cable and pipe layout



**SIMPLE » SAFE » SECURE**

## NTSROOF® SUPER-CHARGED all-in-one PV solution

To ensure compliance with 2025 Future Homes Standards and benefit from the market-leading energy efficiency of NTSROOF - we will be bringing to you NTSROOF® SUPER-CHARGED, the all-in-one PV solution.

An integrated roof system complete with a PV unit and 10 metre cable ready to plug into the mains. Our qualified installers connect the system to any junction box in the house.

The majority of the components are pre-installed in our factory or on the ground, allowing for a significant reduction in install time on site. Typically, one NTSROOF SUPER-CHARGED can be fitted and connected in a day.

With NTSROOF's 300+mm ceiling depth, you can achieve a U value exceeding 0.1W/m²K. By using panels that offer a U value of 0.14W/m²K, you can easily attain an area weighted average of 0.11W/m²K with as few as 7 cassettes.



### Benefits of NTSROOF® SUPER-CHARGED:

- Plug and use solution - no need for complex PV installation or configuration
- We partner with a network of highly capable installers to deliver a comprehensive integrated solution
- Add up to 20m² of hidden PV panels, discreetly concealed from the road
- Integrated wire systems and dwarf wall battery packs included
- No unsightly steel beams or padstones

**SIMPLE » SAFE » SECURE**



# NTSROOF®



This fully designed and engineered panelised roof system, in production since 2015, offers a proven 'room in the roof' warm roof solution.

Our dedicated NTSROOF team provide exceptional support throughout the design, fabrication and install process including site visits, detailed packs and technical advice.

The NTSROOF range has been developed for a variety of house types to help housebuilders build faster, safer and more sustainably.

All NTSROOF products have thermal values which help housebuilders to be 2021 Part L compliant and improve health and safety on site through reduced time working at height.

Once delivered to site the component panels can be craned into position straight away. This eliminates the handling and management of multiple products and trades on site, reducing labour costs.

NTSROOF is fully compliant with NHBC requirements when built in accordance with National Timber Systems' installation instructions and the housebuilder's specifications.

We have the capacity to design, fabricate and deliver thousands of roofs per year.



## Benefits of the NTSROOF®

### Panelised Roof System

- On-site construction time and labour costs are reduced
- 4 roofs can be installed in 1 day due to its simple but innovative design
- Factory fabrication improves dimensional accuracy
- Meets insulation standards for Building Regulations A, D, and L
- Industry leading Psi values
- Robust Details & NHBC compliant
- We have the capacity to design, fabricate & deliver thousands of roofs per year.
- NTSROOF the Simple Safe Secure Solution
- NTSROOF system = less on site



## NTSROOF Supply with Assist

Supply with Assist - a support package for your Supply-Only Contracts.

Offering a comprehensive training plan, detailed drawings, RAMS guidance, a dedicated helpline, site-specific training, and an install plan review – to aid faster installs using our 'less on site' philosophy.

*Designed for a simple. safe. secure installation.*



**SIMPLE » SAFE » SECURE**

**SIMPLE » SAFE » SECURE**



# ROOF & FLOOR CASSETTES

We manufacture both roof and floor cassettes which are ideal for faster build timber frame.

Roof cassettes are pre-insulated to achieve impressive thermal values as low as 0.09W/m²K. They are fitted with a peel away cover for transportation and protection on site and are supplied up to 13 metres long in a range of depths from 200mm to 400mm.

We have manufactured and supplied 500,000 sqm of NTSROOF for housing projects and an additional 160,000 sqm of roof and floor cassettes for housing, schools, hospitals, and modular build projects since 2008.

Roof and floor cassettes not only offer significant increases to the speed of build on site, they also significantly reduce time spent working at height.

Our roof and floor cassettes are constructed using STEICO joists with in-built lifting straps for easy transportation, offload and installation.

## Benefits of our Roof and Floor Cassettes:

- Large spans due to engineered joist construction
- Impressive dimensional accuracy & reliable build quality
- Improved on site safety & reduced working at height
- Complete design, fabrication & delivery service
- Dramatically reduces the build programme when compared to traditional build methods



DESIGNED » FABRICATED » DELIVERED

# ENGINEERED JOISTS

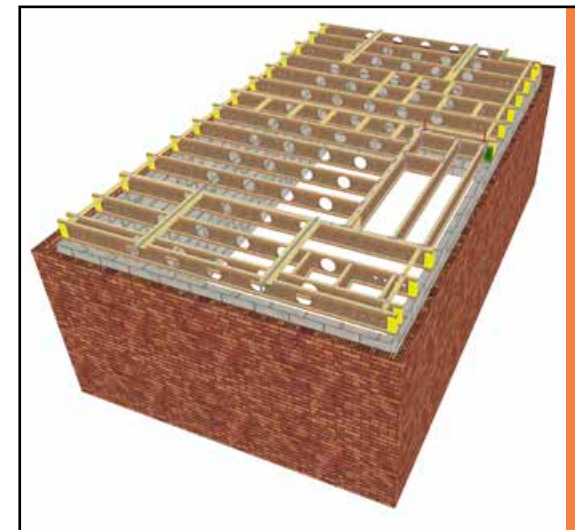

## PREMIUM JOISTS WITH SERVICE HOLES

Bringing you a range of premium joists featuring pre-machined service holes strategically placed, simplifying the way you accommodate HVAC, plumbing, and wiring system installations.

### Benefits of our premium joists range

- Pre-machined holes for a seamless installation
- Faster project completion and reduced labour costs
- Quality craftsmanship - elevating your construction standards
- Easily accommodates the installation of HVAC, plumbing and wiring systems

Our in-house design team creates tailor-made engineered joist solutions for projects of all sizes, including individual floors, full site plans, and complex commercial structures.



DESIGNED » FABRICATED » DELIVERED



# METAL WEB JOISTS

Metal web joists are engineered to optimise efficiency in construction projects. With advanced versatility and precision engineering, these joists offer ultimate performance.

Whether you're simplifying installations or enhancing design capabilities, our Metal Web Joists set a new standard for builders and architects, providing superior structural support and flexibility.

## Benefits of Metal Web Joists

- Flexibility: Install wiring, plumbing, cabling, and ducting without predetermined positions
- Retrofitting Made Easy: Streamline services without drilling holes
- Bespoke Design: Longer spans, quicker assembly, and superior flexibility
- Precision Engineering: Fine-tuned to meet load requirements and design to certain deflection criteria
- Reduced Risk: Minimise shrinkage and eliminate squeaky floors
- Minimised Wastage: Tailored to minimise site wastage
- Adjustability: Solid timber "trimmable ends" for on-site variations
- Ease of Handling: Lightweight open-webbed structure
- Architectural Freedom: Eliminate loadbearing walls for more design options
- Simplified Installation: Wide chords for easy nailing / screwing
- Universal Application: Ideal for various projects - new construction and restoration alike.
- Suitable for use for floors (commercial and residential) and roofs (flat and pitched).

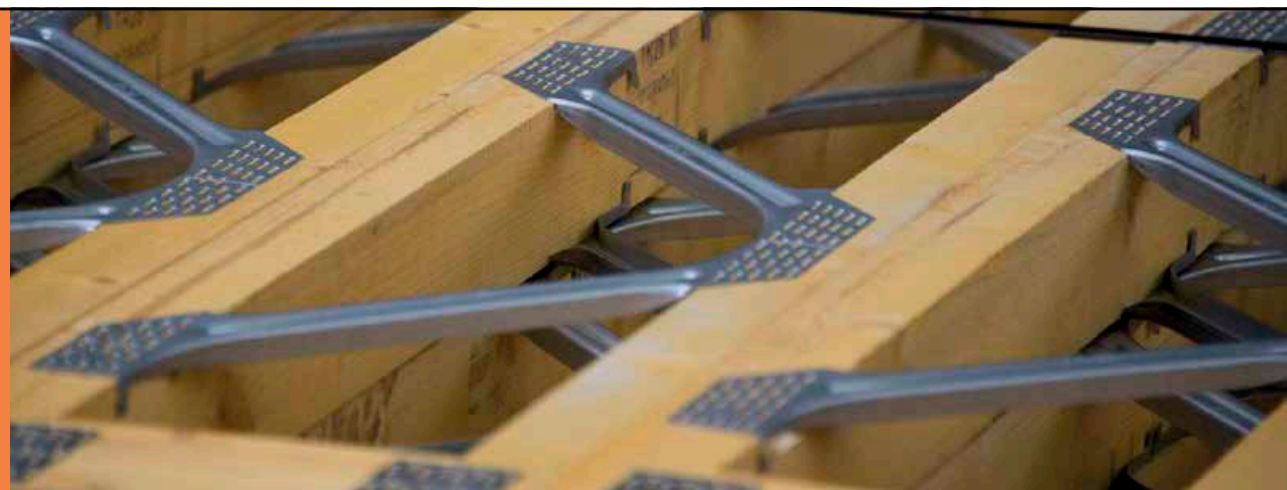

DESIGNED » FABRICATED » DELIVERED

# TRUSSED RAFTERS

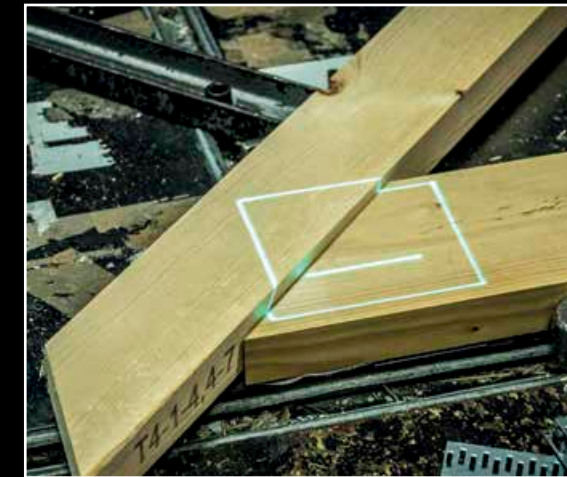

Our impressive roof solutions team offers all types of roof trusses from finks and attic trusses to complex roof trusses and spandrel panels. We supply whole housing schemes, individual homes and commercial buildings such as care homes and utility buildings.

Using the very latest MiTek® software, which incorporates the new and innovative Pamir design package, our expert designers can design roof trusses to meet your exact requirements.

Our dedicated fleet can deliver to all areas of the UK.

## Benefits of our Trussed Rafters:

- UKCA Marking accredited.
- ISO9001 accredited
- Laser image-projecting technology
- MiTek® software incorporating Pamir.
- Large team of experienced truss & press fabricators.
- State of the art cutting and pressing machinery.
- Full technical & engineering support.
- Complete design, fabrication & delivery service.
- Quick turnaround from design to delivery.
- Manufactured from PEFC or FSC® certified timber



DESIGNED » FABRICATED » DELIVERED



# GABLE & PARTY PANELS



Our expert team design can manufacture panels for both gable and party walls. Our panels can be used for timber frame and masonry construction and are simple to install with no complex anchorage needed. They can be supplied for most roof sizes, layouts and levels of complexity.

Panels offer a significant increase to the speed of build on site and they significantly reduce the length of time at which multiple tradesmen are working at height.

Our party wall panels are clad with a layer of 15mm fermacell, which negates the need for factory wrapping, as well as the need to remove and dispose of polythene packaging.

Our dedicated team design each project to comply with your fire, sound and structural requirements to meet regulations.

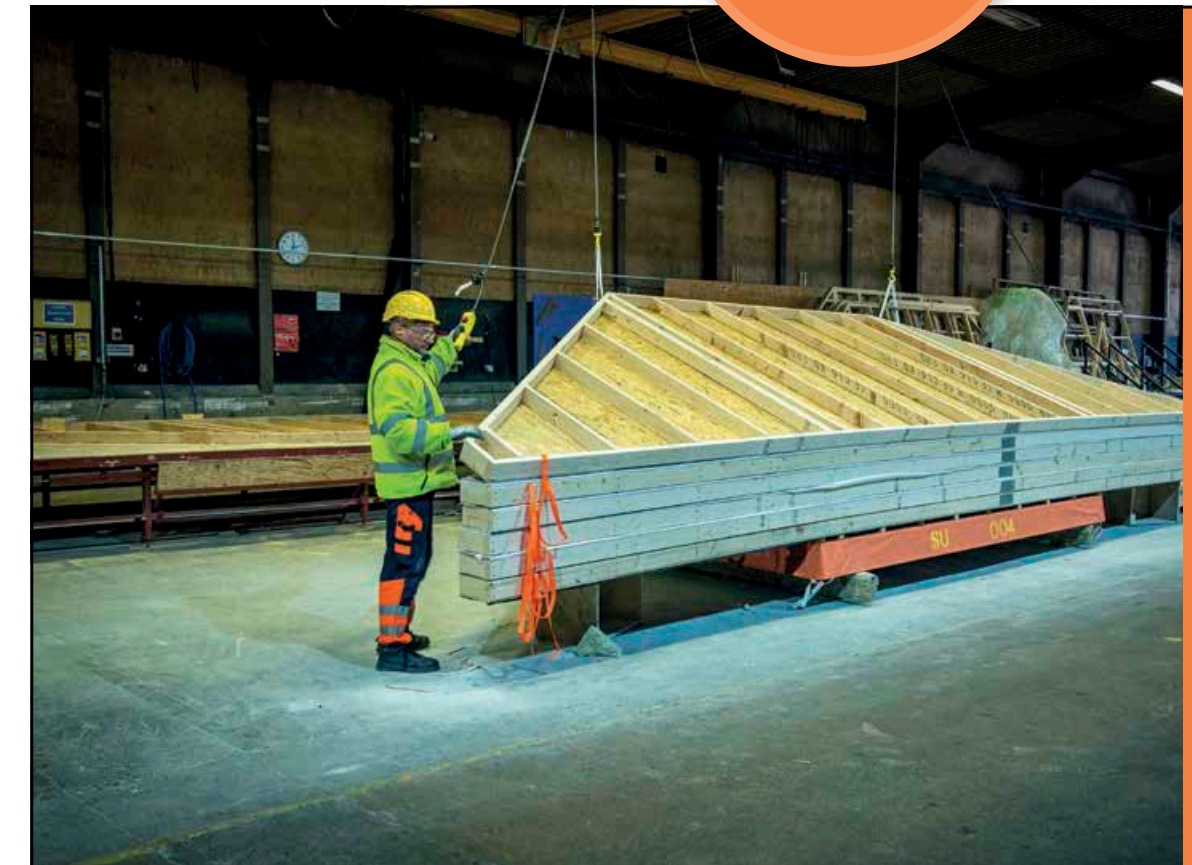

## EXPERT DESIGN SERVICE FROM PLAN

### Benefits of our Spandrel Panels:

- Cost effective solution which dramatically increases speed of build
- Reduces amount of time working at height
- Just one trade required during roof construction
- No interruption to work for gable wall & roof construction
- Experience & expertise
- Complete design, fabrication & delivery service
- Quick turnaround from design to delivery
- Party spandrels can provide 60 minutes fire protection

**EXPERT**  
DESIGN SERVICE  
FROM PLAN

DESIGNED » FABRICATED » DELIVERED

DESIGNED » FABRICATED » DELIVERED



# KEY SUPPLIER

**E EGGER**

## EGGER Peel Clean Xtra

- P5 grade chipboard with an easy-to-peel, anti-slip woven surface film which helps prevent moisture ingress
- When trades have finished, remove the film for a clean, well-presented floor
- Low slip potential in wet conditions in accordance with HSE guidelines.
- Can be left exposed to the elements for up to 60 days



## EGGER Protect

- Durable, anti-slip weather resistant surface layer bonded to both sides of the board for protection against moisture ingress for the life of the floor
- Once fully fitted, can be exposed for up to 60 days
- Unique, anti-slip surface, even when wet contributing to site safety

## EGGER Joint & Joist Adhesive

- No need for expensive tapes or applicator guns to cover board joints
- Unique foaming action, ideal for gap filling on uneven surfaces and joists
- Helps minimise squeaks associated with fully nailed floors
- 18 month shelf life from date of manufacture

## EGGER Advanced Structural Flooring System

Our EGGER Advanced Lifetime Guarantee covers the structural performance of your finished floor. Simply follow the three steps of the EGGER Advanced Structural Flooring System to benefit.

1. Select a board from the EGGER Advanced range
2. Use EGGER Joint & Joist Adhesive
3. Fit to the EGGER Advanced Structural Flooring Fitting Guide

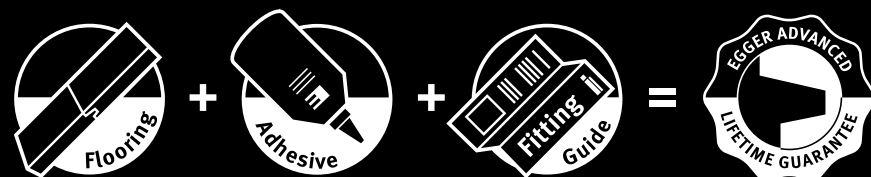

MORE FROM WOOD.

# QUALITY COMMITMENT



## Our commitment to Quality *Getting it right first time*

Our manufacturing centres are ISO 9001 accredited, reflecting our unwavering dedication to quality, which is the foundation of our reputation, customer trust, and overall success. At NTS, we view quality as a journey that we embark on together, hand in hand, to ensure that every aspect of our business reflects our commitment to excellence **and confidence in your investment.**

Our "Quality Matters" campaign epitomises our commitment to excellence. Through rigorous processes and meticulous attention to detail, we aim to deliver nothing short of exceptional quality to our customers.

From the manufacturing process to documentation, quality remains our top priority at every stage. We take great pride in our dedication to providing premium products consistently across all our manufacturing sites.

*Our steadfast dedication to quality ensures that each project is executed to the highest standards, giving you peace of mind.*



**QUALITY MATTERS**

DESIGNED » FABRICATED » DELIVERED



# SUSTAINABILITY

Sustainability is central to our operations and environmental commitment.

Our goal is to reduce biodiversity and ecosystem impacts through sustainable forestry. We ensure responsible sourcing by using timber from sustainably managed forests certified by FSC® or PEFC.

We continuously monitor on-site activities to minimise environmental impact. By prioritising sustainability, we provide high-quality timber products that align with customer values while reducing environmental and social impacts.

**To cut waste and greenhouse gas emissions, we implement initiatives such as:**

- Transitioning to fully hybrid/electric employee car scheme
- GoGreen Sustainable Waste Management
- Goal of 0% to Landfill
- FutureTrack carbon management and emission monitoring

Find out more: [ntsenquiries@nationaltimbersystems.co.uk](mailto:ntsenquiries@nationaltimbersystems.co.uk)

**As a responsible business we are committed to:**



DESIGNED » FABRICATED » DELIVERED

# CERTIFICATION



## ISO 9001

We hold ISO 9001 accreditation, reflecting our dedication to maintaining the highest standards of quality, efficiency, and customer satisfaction.



## UKCA Marking:

We are UKCA (United Kingdom Conformity Assessment) Mark certified.

To gain UKCA Mark we must demonstrate we have factory production controls and systems in place to issue a declaration of performance on the product.

We are audited by external certification bodies annually to ensure standards are met.



## Trussed Rafter Association (TRA):

We are a member of the TRA. This association offers technical advice for all aspects of roof trusses and spandrel panels.



## Robust Details

Secured for the NTSROOF, the robustdetails® scheme is the alternative to pre-completion sound testing for satisfying Part E of the Building Regulations. Using the scheme avoids the uncertainties of pre-completion sound testing.



## FSC® & PEFC:

Our products carry Forest Stewardship Council® (FSC®) or Programme for the Endorsement of Forest Certification (PEFC) chain of custody certification that is independently evaluated, certified and available upon request.

The Forest Stewardship Council® (FSC®) is an international, non-governmental organisation dedicated to promoting responsible management of the world's forests.

PEFC is an international non-profit, non-governmental organisation dedicated to promoting Sustainable Forest Management (SFM) through independent third party certification.



## Veriforce CHAS®

NTS is proud to be CHAS accredited by Veriforce CHAS, the UK's leading compliance and risk management provider. This demonstrates our commitment to high standards in health, safety, and supply chain compliance.

DESIGNED » FABRICATED » DELIVERED



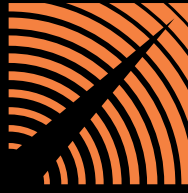

DESIGNED >> FABRICATED >> DELIVERED



+ Roof Trusses + Engineered Joists  
+ NTSROOF® Panelised System  
+ Roof & Floor Cassettes + Gable & Party Panels

### National Timber Systems Head Office

Standard House | Thurston Road  
Northallerton | North Yorkshire | DL6 2NA

t 01609 780777

e [ntsenquiries@nationaltimbersystems.co.uk](mailto:ntsenquiries@nationaltimbersystems.co.uk)

w [nationaltimbersystems.co.uk](http://nationaltimbersystems.co.uk)



**NATIONAL  
TIMBER SYSTEMS**

Part of National Timber Group